

Satellite Rewiring

What's in this Chapter

- “Source of Information” on page 1
- “Photos” on page 2

1.1 Source of Information

These photos are taken from the following Web site:

http://www.r-visioncamping.org/modules.php?set_albumName=satmod&op=modload&name=gallery&file=index&include=view_album.php.

Note: *These images were acquired on 9/21/04. There's no guarantee that the files will remain on this site or that the URL will continue to be usable. Unfortunately, nothing is known about the creator of these images, other than the name "nc_camper".*

1.2 Photos

Figure 1



Before the Mod - Paul (nc_camper)

Description: This is the Amplifier faceplate (ok, I know the amplifier is in the Antenna assembly) before the modification.

Figure 2



Existing cabling - Paul (nc_camper)

Description: Removing the faceplate, you can see that there is sufficient cable slack to have work space...

Figure 3

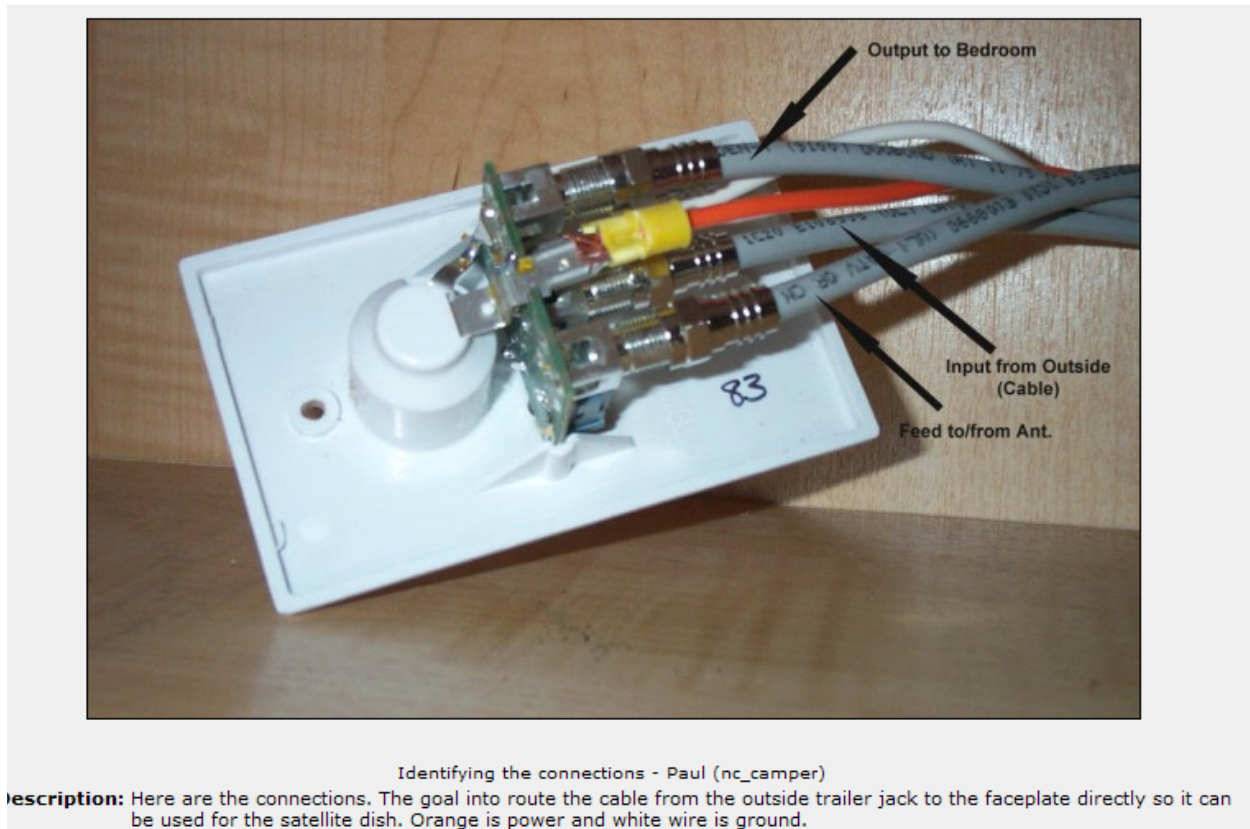

Figure 4



Figure 5



Figure 6

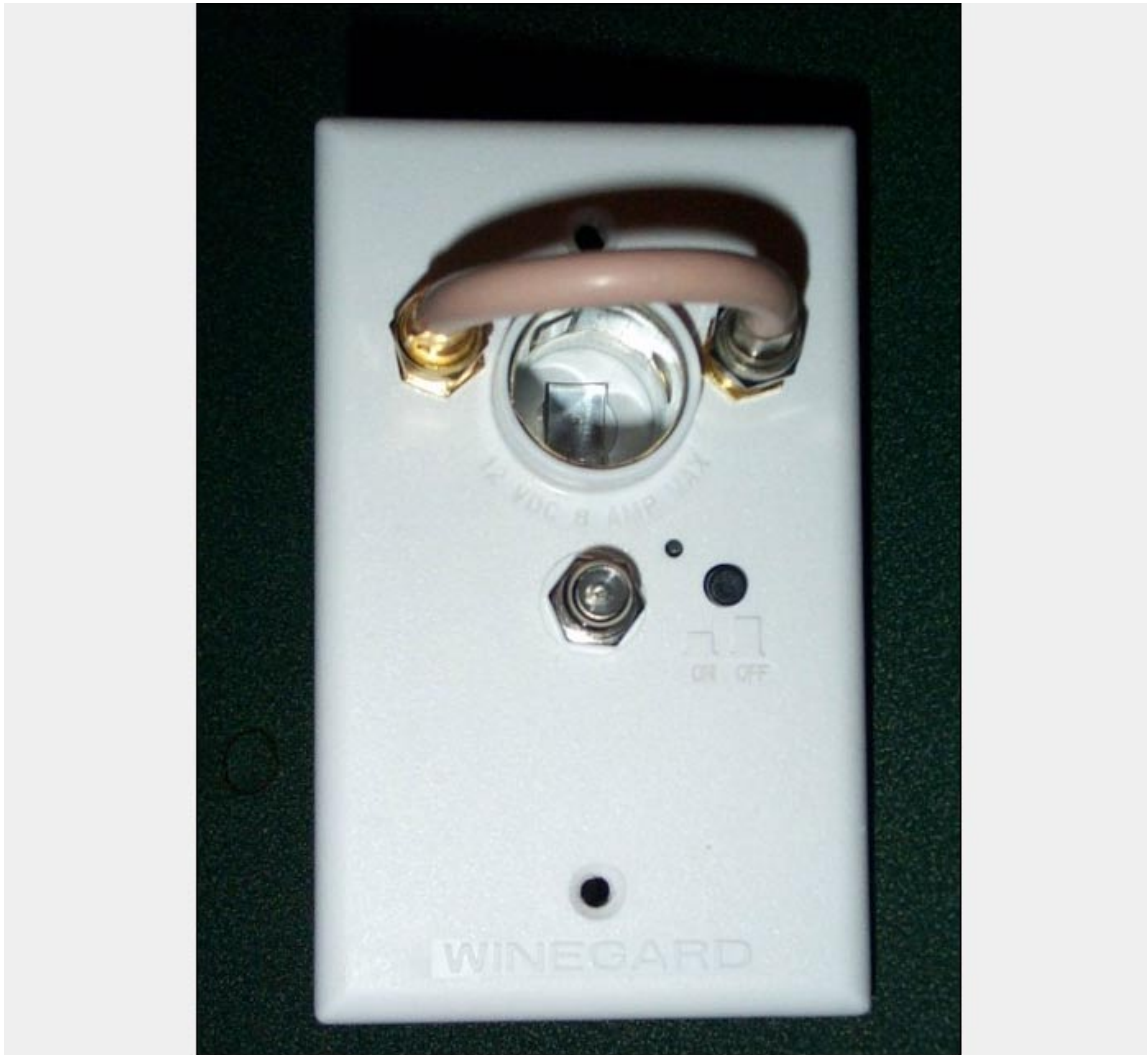

Campsite cable config. - Paul (nc_camper)

Description: A small jumper is required to allow the use of cable at a campsite as if the modification had not been made.

Figure 7

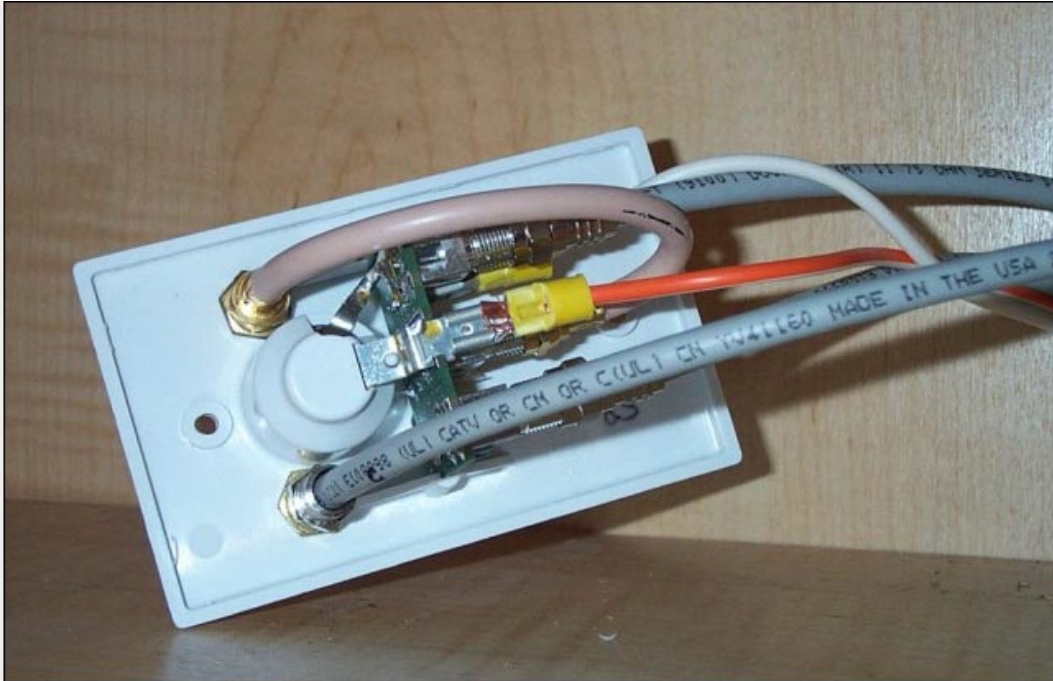

All connections reconnected! - Paul (nc_camper)

Description: New configuration is reconnected and ready. OOPS - had to get out the dremel tool to make room in the paneling for the new jacks.

Figure 8



All installed - Paul (nc_camper)

Description: And it's the completed mod. To run the satellite, the top right jack is connected to the Satellite receiver. And if you want to watch satellite in the bedroom, then connect the TV out from the satellite to the top left jack and make sure the power switch is off on the wallplate.